

# OHCETA Simulation Conference

Moore-Norman Technology Center – South Penn  
Campus

13301 S. Pennsylvania Ave., Oklahoma City, OK 73170

**“The Essentials, Progression, and Future of Simulations in Nursing Education.”**

May 18th, 2023

Presented By:

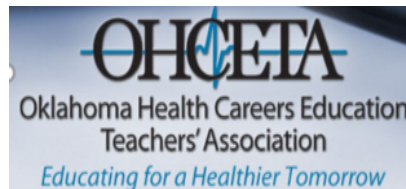

## Who Should Attend?

Those responsible for training and evaluating nurses, emergency responders, allied health professionals, and any healthcare professional in either an academic or practice setting.

### Keynote

"The Essentials, Progression, and Future of Simulations in Nursing Education."



Pamela R. Jeffries, PhD, RN, FAAN, ANEF, FSSH, is Dean of Vanderbilt University School of Nursing and holds the Valere Potter Distinguished Chair in Nursing. Dr. Jeffries is internationally known for her research and work in nursing, simulation, and health care. Throughout the academic community, she is recognized for her scholarly contributions to executive leadership, the development of innovative teaching strategies, experiential learning techniques, new pedagogies, and the delivery of content using technology. As Principal Investigator on grants funded by federal and state agencies and numerous national organizations, including the National League for Nursing (NLN) and the National Council of State Boards of Nursing, Dr. Jeffries has provided leadership and mentorship on ground-breaking projects impacting both nursing practice and education. With the NLN, Dr. Jeffries developed the major contribution to simulation scholarship, the framework and monograph now known as the NLN Jeffries Simulation Theory.

## Breakout Sessions:

### *“How to be successful on the CHSE”*

In this session you will learn how those in Oklahoma are studying and preparing for the CHSE. We have multiple simulation faculty in our state that have successfully taken and passed the CHSE. Learn how they did it and possibly find a study group to work together to pass this professional examination. If you have any desire to take this exam this year, this session is for you.

### *“Roadmap to Simulation”*

Are you just starting in simulation? Everyone keep talking about INACSL standards and you have no idea what they are talking about? This session is for you. We will guide you on what the standards are, why they are important and how to start meeting them in your own program.

### *“Hands-on Training with Laerdal Experts”*

#### Laerdal

The purpose of this workshop is to allow for hands-on training with real simulators. This will be designed so that both novice and experienced alike, will be able to learn something. This will also be a great opportunity to see the new products coming out from Laerdal.

### *“Training with Gaumard Experts”*

#### Gaumard

The purpose of this workshop is to allow for hands-on training with real simulators. This will be a great opportunity to work with product experts and

fellow healthcare professionals. This will be interactive and will be designed for both novices and experienced both.

### *“Simulation design”*

The purpose of this simulation is to help participants learn the ins and outs of simulation design. How do you design a simulation from start to finish. Our team of simulation coordinator and simulation operations specialist will show you how they work together to design simulations for their nursing students.

### *“From start to finish”*

In this session we will go through an entire day of simulation from start to finish. Many times, we go to conference and get pieces of the puzzle, but this session is designed to put all of those puzzle pieces together. It will be an interactive session.

### *“Debriefing 101”*

Many of the programs in Oklahoma are using the debriefing for meaningful learning model (DML) for debriefing in simulation. In this session we will look at how you can modify this model to work for your program. This will be interactive and will give hands-on experience.

### *“I have the CHSE, now what?”*

In this session we will look at what the requirements are for those that have the CHSE. This will include obligations as far as training others and what is

required for the recertification process. This will be a round table discussion.

### *“VR in simulation education”*

The purpose of this workshop is to allow for hands-on training with VR technology. VR is a great way to get participants involved in a fun interactive way. This can be used in technology centers, higher education and hospital-based centers. This will be an interactive session.

### *“All on the same team”*

The purpose of this workshop is to have interactive discussions about how our programs do simulation and what ideas we can take from one another to make our educational experience better. This will be round table discussion and limited in space.

### *“Mass Casualty”*

Learn from one of the very best how to execute a mass casualty simulation. This session will help the educational institutions, but also the hospital partners that partner together to create these realistic experiences. You will get to see a recent video of a mass casualty that Metro Tech put on in partnership with citywide programs.

*The Agenda*  
*May 18th, 2023*

<i>8:30 am-9:00 am</i>	<i>Registration Check-In</i>
<i>9:00 am-9:15 am</i>	<i>Welcome, Introductions, Review Agenda</i>
<i>9:15 am-10:15 am</i>	<b>Keynote-</b> <i>Dr. Jeffries</i>
<i>10:15 am-10:30am</i>	<b>Break</b>
<i>10:30am-11:30am</i>	<b>Breakout Sessions:</b>  <i>“How to be successful on the CHSE”</i>  <i>“Roadmap to Simulation”</i>  <i>“Hands-on Training with Laerdal Experts”</i>  <i>“Training with Gaumard Experts”</i>  <i>“All on the Same Team”</i>  <i>“VR in simulation education”</i>
<i>11:30 am-12:30pm</i>	<b>Lunch</b>
<i>12:30 pm – 1:30 pm</i>	<b>Breakout Sessions:</b>  <i>“Hands-on Training with Laerdal Experts”</i>

*“Training with Gaumard Experts”*

*“Mass Casualty”*

*“How to be successful on the CHSE”*

*“Simulation design”*

*“From start to finish”*

*1:30 pm-1:45pm*

**Break**

*1:45 pm – 2:45 pm*

**Breakout Sessions:**

*“Hands-on Training with Laerdal Experts”*

*“Training with Gaumard Experts”*

*“Debriefing 101”*

*“I have the CHSE, now what?”*

*“Roadmap to Simulation”*

*“From start to finish”*

*2:45 pm-3:00 pm*

**Wrap Up, Survey, Certificates**

## **Address, Directions and Parking Information**

### **Location**

Moore-Norman Technology Ctr.  
(South Penn campus)  
13301 S. Pennsylvania Ave.  
Oklahoma City, OK 73170  
(405) 364-5763

### **Directions**

#### **Southbound & Northbound from I-35:**

Take Exit 117 at SW 4th St, Moore, then travel west approximately 3 miles to SW 134th and S. Pennsylvania. The street name changes from SW 4th in Moore to SW 134th Street in Oklahoma City.

#### **Southbound & Northbound on I-44:**

Take Exit 110 at SW 134th St. Travel east 2.5 miles to SW 134th and S. Pennsylvania. The campus is located on the northwest corner.

### **Parking**

Attendees can park in north or west parking lots (see red circles on map). Registration will be on the 1st Floor of the Main Building, Lower Level in the Conference Center



## SOUTH PENN CAMPUS

**DIRECTIONS | SOUTHBOWN and NORTHBOWN from I-35**  
Take Exit 117 at SW 4th St., Moore, then travel west approximately 3 miles to SW 134th & S. Pennsylvania. The street name changes from SW 4th in Moore to SW 134th Street in Oklahoma City.

**SOUTHBOWN and NORTHBOWN on I-44**  
Take Exit 110 at SW 134th Street. Travel east 2.5 miles to SW 134th & South Pennsylvania. The campus is located on the northwest corner.

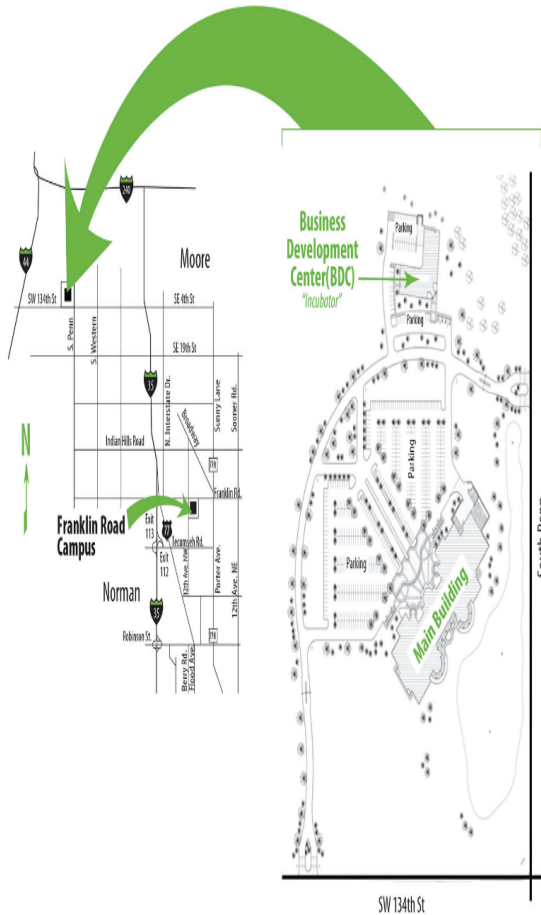

## MAIN BUILDING Lower Level

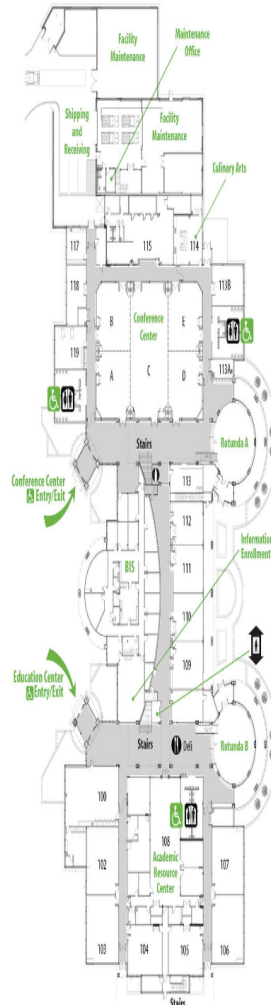

## MAIN BUILDING Upper Level

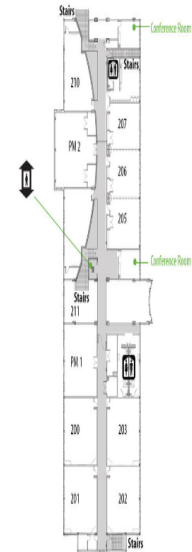

Legend	
	Vending
	Restroom
	Elevator
	Cafeteria
	ADA Accessible

## BUSINESS DEVELOPMENT CENTER "Incubator"



It is the policy of Moore Norman Technology Center to not condone discrimination with regard to race, color, national origin, religion, gender, sex, age, disability or veteran status in enrollment or employment, nor in the educational programs or activities which it operates. MNCTC Human Resources Director or the compliance coordinator handles inquiries concerning application of this policy. If referred to this office, MNCTC provides reasonable accommodations and support for students with disabilities and special education needs covered by the Americans with Disabilities Act, Section 504 of the Rehabilitation Act of 1973, and individuals with Disabilities Education Act (IDEA).

REVISED 10/20/2012

**“The Essentials, Progression, and Future of Simulations in Nursing Education.”**

May 18th, 2023

Registration & Continental Breakfast Starting at 8:30 am

**Conference:** 9:00 am- 3:00 pm

**Presented by** Oklahoma Health Careers Education Teachers Association, Moore-Norman Technology Center, and Laerdal.

## Registration and Payment Information

**Registration Cost-** The cost of the conference is \$150 per person (or \$125 per person for groups of 4 or more registered prior to May 1st, 2023) and includes breakfast, lunch, and snacks. For those registering on or after May 2nd, 2023, the cost of the conference will be \$200. Those using purchase orders will be invoiced after the conference.

**Cancellation Policy-** If you are registered and will be unable to attend, your payment will be applied to next year's Spring Simulation Conference.

### **The address for mailing checks is:**

If paying by check, please make check payable to Oklahoma Health Careers Education Teachers' Association. (please note OHCETA Sim Conf in the memo line of the check).

Oklahoma Health Careers Education Teachers' Association 1500 W 7th Ave, Stillwater, OK 74074

For questions about registration or payment, please contact Natasha Trotter at [natasha.trotter@netech.edu](mailto:natasha.trotter@netech.edu) or Lara Morris at [lara.morris@careertech.ok.gov](mailto:lara.morris@careertech.ok.gov)

**Registration Form Link** – Please register online at the following link <https://ohcwc.wufoo.com/forms/ohceta-2023-simulation-conference/>